

B-Vent and Chimney Liners

Type B Round

Type B Oval

Flexible Connectors

Chimney Liners



TABLE OF CONTENTS

Stainless Steel Chimney Liner - Model SLK

Technical Information 3

Product Descriptions and Dimensions4-5

Type B Gas Vent (Round and Oval)

Technical Information 6

Termination Height Table..... 7

Offset Chart 7

System Design 8

Typical Installations 9

Type B Gas Vent - Round

Product Descriptions and Dimenstions..... 10-22

Type B Gas Vent - Oval

Product Descriptions and Dimensions23-28

Gas Vent Connectors

Specifications 29

Product Descriptions and Dimensions30-31

Aluminum Chimney Liners

Product Descriptions and Dimensions 32

Typical Installations 33



Model SLK Stainless Steel Chimney Liner is the superior choice for relining masonry chimneys for use with oil, wood, coal and noncondensing gas-fired appliances. In addition to the kit, we also provide accessories that allow for an easier installation. These accessories include a pull down used to stretch and lead the flexible liner down the chimney and a flex connector that joins flex lengths, flex to tee length and flex to appliance outlet. All kits have a limited lifetime warranty.



Construction Features

- Made from .005" thick, corrosion-resistant, type 316 stainless steel
- Available in 4" – 8" diameters with 25' and 35' lengths
- 25' and 35' individual lengths and 10' insulated sleeves for improved venting in cold climates also available
- 10' insulated sleeves include 10' of insulation wrap, 10' of wire mesh, wire ties, and 14' of foil tape or aluminum tape
- Stainless Tee features a 14" detachable branch for ease of installation
- Flashing with a 24" x 24" base plate

Complete Flex kit includes:



Rain Cap



Flashing Adapter



Flashing



Flexible Liner



Flexible Connector



Swivel Tee



Tee Cap



STAINLESS STEEL CHIMNEY LINER - MODEL SLK

COMPLETE FLEX KITS



- Tighter compression for convenient storage and transport
- 10' insulated sleeves include 10' wrap, 10' of wire mesh, wire ties, and 14' of foil tape or aluminum tape
- Large 24" x 24" flashing base

PART #	PRODUCT CODE	DIAMETER
--------	--------------	----------

25' Complete Flex Kit

4SLK25	893016	4"
5SLK25	893018	5"
6SLK25	893020	6"
7SLK25	893022	7"
8SLK25	893024	8"

35' Complete Flex Kit

4SLK35	893017	4"
5SLK35	893019	5"
6SLK35	893021	6"
7SLK35	893023	7"
8SLK35	893025	8"

STAINLESS FLEX LENGTHS

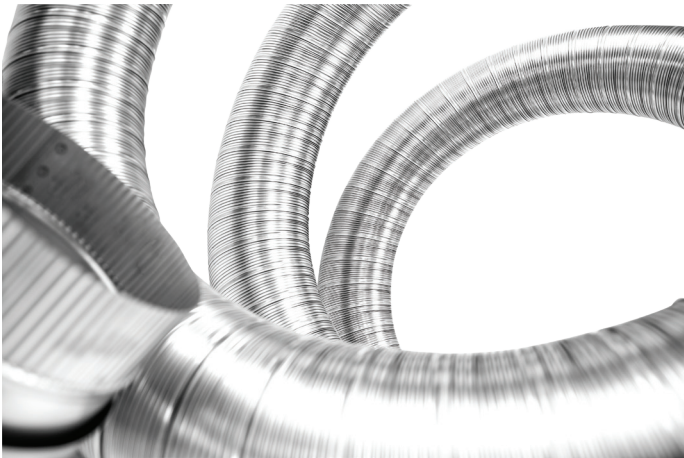

PART #	PRODUCT CODE	DIAMETER
--------	--------------	----------

25' Stainless Flex Length

4SL-25L	893597	4"
5SL-25L	893598	5"
6SL-25L	893599	6"
7SL-25L	893600	7"
8SL-25L	893601	8"

35' Stainless Flex Length

4SL-35L	893602	4"
5SL-35L	893603	5"
6SL-35L	893604	6"
7SL-35L	893605	7"
8SL-35L	893606	8"

- Made from .005" thick, corrosion-resistant, type 316 stainless steel



PULL DOWNS



PART #	PRODUCT CODE	DIAMETER
4FX-PD	882986	4"
5FX-PD	882978	5"
6FX-PD	882989	6"
7FX-PD	882990	7"
8FX-PD	882991	8"

- Used to stretch and lead the flexible liner down the chimney

FLEXIBLE CONNECTOR



PART #	PRODUCT CODE	DIAMETER
4FX-FC	893036	4"
5FX-FC	893037	5"
6FX-FC	893038	6"
7FX-FC	893039	7"
8FX-FC	893035	8"

- Joins flex lengths, flex to tee length, a flex to appliance outlet

INSULATION SLEEVES



PART #	PRODUCT CODE	DIAMETER
10' Insulation Sleeve		
5SL-10I	893593	5"
6SL-10I	893594	6"
7SL-10I	893595	7"
8SL-10I	893596	8"

For 4" diameter liner, use 5" insulation sleeve

- 25' and 35' individual lengths and 10' insulated sleeves improve venting in cold climates
- 10' insulated sleeves include 10' of insulation wrap, 10' of wire mesh, hose clamps and 14' of foil

Model Type B Gas Vent is used for venting all Category 1 listed gas appliances having draft hoods and other appliances listed to be used with Type B Gas Vent. For more information on venting unlisted gas appliances or appliances burning solid or liquid fuels, request our All-Fuel Chimney catalog.

Certification & Applications



Amerivent is a pioneer in the development and simplification of effective venting products since 1951, Amerivent components are crafted for today’s building and appliance requirements. For any Type B gas venting, you will find Amerivent has the most complete line of pipe and accessories.

One of the fire safety features of double-wall Type B gas vent is that its outer wall, insulated by the airspace beneath it requires only 1” clearance to combustible material in the structure. Amerivent is a complete gas venting system, from draft hood connectors to termination caps. Whatever your gas venting needs (from 3” to 30” pipe diameters in 7 different pipe lengths, from single to multi-appliance hook-ups) you can create almost any system from our more than 350 coordinated parts. Featuring Snap-Lock joints that are quick and easy to connect and disconnect, the Amerivent Type B gas vent system is lightweight with no sacrifice in strength, and is available in large sizes, adjustable components, and multi-story Type BW venting installation.

Product Description

The Type B designation is assigned to gas venting systems that meet the safety requirements of Underwriters Laboratories, Inc. The Amerivent all-metal, double-wall gas vent is listed as Type B by UL and is approved for residential and commercial applications such as Category 1 water heaters, boilers, furnaces, space heaters, or wall heaters. UL-approved Type B gas vent products form a continuous passageway from an approved gas appliance to the termination of the vent above the roof of the structure.



Specifications and Dimensions

Pipe Sizes

3", 4", 5" 6", 7", 8"
9", 10", 12", 14", 16", 18",
20", 22", 24", 26", 28", 30"

Pipe Lengths

6", 12", 18", 24", 3', 4', 5' (except 8" size)
12", 18", 24", 3'

Oval

Pipe Sizes

4", 5", 6"

Pipe Lengths

6", 12", 18", 24", 3', 4', 5'
6", 12", 18", 24", 3'

Maximum Height

Unlimited if properly supported

Insulation

½ BTU per hour per square foot per degree F temperature differential
(U factor = 0.5)

**Approved,
Accepted,
or Listed by**

AGA, NFPA, HUD, NBC, UBC
Underwriters Laboratories, Inc. to UL441 test standard

How to Specify

Gas vents shall be UL-listed Amerivent Gas Vent or equal installed in accordance with terms of the UL-listing and the manufacturer’s published instructions.

The Amerivent Type B Quick Disconnect System

To Connect: Snap-lock pipe and fittings together

To Disengage the Locking Tab: Align the seams and pull apart

Locking Tab: To ensure a secure fit, push in the locking tab to lock the pipes together

Engagement: Snap-lock joints overlap - to calculate height deduct 1" for each joint

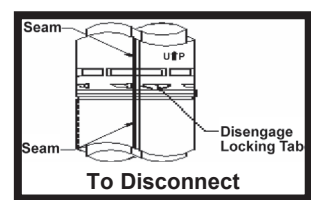
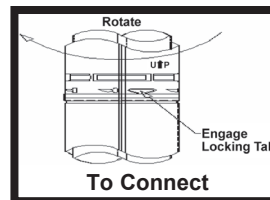



GAS VENT TABLES - ROUND AND OVAL

TERMINATION HEIGHT TABLE

Amerivent caps in 3" through 12" sizes may be installed in accordance with the Gas Vent Termination Table if the vent is at least 8' from any vertical wall. For installation of caps 14" and larger, or for caps that are less than 8' from a vertical wall, the cap is to be located no less than 2' above the highest point where the vent passes through the roof and at least 2' higher than any portion of a building within 10'.

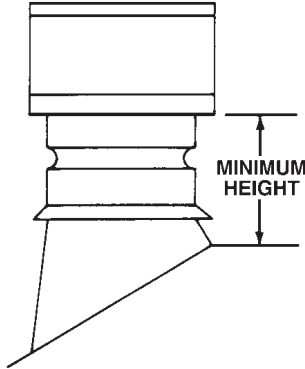

ROOF PITCH		MINIMUM HEIGHT
Flat	to 7/12	1 ft
Over	7/12 to 8/12	1 ½ ft
Over	8/12 to 9/12	2 ft
Over	9/12 to 10/12	2 ½ ft
Over	10/12 to 11/12	3 ¼ ft
Over	11/12 to 12/12	4 ft
Over	12/12 to 14/12	5 ft
Over	14/12 to 16/12	6 ft
Over	16/12 to 18/12	7 ft
Over	18/12 to 20/12	7 ½ ft
Over	20/12 to 21/12	8 ft

OFFSET TABLE

This table is used to determine the offset produced by two Amerivent 45° adjustable elbows set at the maximum angle of 45°. Also shown are the offsets produced by introducing various lengths of Amerivent between the two elbows.

Maximum Offset in Inches

VENT SIZE	(2) 45° ELBOWS	LENGTH						
		(1) 6"	(1) 12"	(1) 18"	(1) 24"	(1) 3'	(1) 4'	(1) 5'
3	3 ¼"	6 ¾"	11"	15 ¼"	19 ½"	28"	36 ½"	45"
4	3 ½"	7"	11 ¼"	15 ½"	19 ¾"	28 ¼"	36 ¾"	45 ¼"
5	4 ¼"	7 ¾"	12"	16 ¼"	20"	29"	37 ½"	46"
6	4 ½"	8"	12 ¼"	16 ½"	20 ¾"	29 ¼"	37 ¾"	46 ¼"
7	5"	8 ½"	12 ¾"	17"	21 ¼"	29 ¾"	38 ¼"	46 ¾"
8	5 ½"	9"	13 ¼"	17 ½"	21 ¾"	30 ¼"		47 ¼"
9	6"		13 ¾"	18"	22 ¼"	30 ¾"		
10	7 ¼"		15"	19 ¼"	23 ½"	32"		
12	7 ¾"		15"	19 ¾"	23 ½"	32"		
14	8 ½"		16 ¼"	20 ½"	24 ¾"	33 ¼"		
16	9 ¼"		17"	21 ¼"	25 ½"	34"		
18	10"		17 ¾"	22"	26 ¼"	34 ¾"		
20	10 ¼"		18"	22 ¼"	26 ½"	35"		
22	10 ¾"		18"	22 ¾"	26 ½"	35"		
24	11 ¼"		19"	23 ¼"	27 ½"	36"		
26	12"		19 ¾"	24"	28 ¼"	36 ¾"		
28	12 ¾"		20 ½"	24 ¾"	29"	37 ½"		
30	13 ½"		21 ¼"	25 ½"	29 ¾"	38 ¼"		

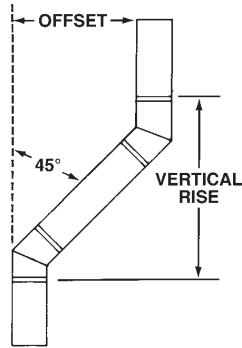

Note: The vertical rise can also be closely estimated by adding one "A" and one "B" dimension to Maximum Offset figures. (See dimensions of Round Adjustable 45° Elbows.)

GAS VENT TABLES - ROUND AND OVAL**SYSTEM DESIGN AND INSTALLATION GUIDES**

The following installation guidelines have been prepared to assist you in your particular application and in installing a vent correctly.

Before laying out a gas vent system for any gas appliance, the installer should first consult the local code and the appliance manufacturer's installation requirements. Only then should you pick your components and design your vent system.

Amerivent offers a wide range of round and oval pipe sizes and adjustable components to provide maximum design flexibility. All three basic gas vent installations (as defined by Underwriters Laboratories, Inc.) can be constructed using Amerivent. These three are:

TYPE B

Amerivent (Sizes 3" through 30" round and sizes 4", 5", and 6" oval) may be installed with 1" minimum clearance to combustibles.

TYPE BW

4" oval Amerivent (when installed in 2 x 4 stud wall with recessed heater) requires clearances as determined by use of 40HD hold-down plate, 40PS ceiling plate spacers, and 40FS firestop spacers.

TYPE B 2 X 4

4" and 5" oval Amerivent (when installed in 2 x 4 stud wall with other than recessed heater) requires clearance as determined by use of 40FS or 50FS firestop spacers at each ceiling level.

To graphically illustrate the use of Amerivent components in typical installations, we offer the diagrams on the next page. Here you'll see just about every Amerivent part and how each contributes to a complete installation.

To guide you in these and other installations, the following general rules should be followed.

1. Provide an adequate air supply. Remember, you must meet local code minimum requirements for both combustion air and draft hood dilution air.
2. Attach vent to appliances draft hood with sheet metal screws and terminate the vent at least 5' above the draft hood. For wall furnaces, vents must terminate at least 12' from bottom of heater. See Gas Vent Termination Table for required height above roof.
3. One gas vent may serve more than one gas appliance. Prudent advanced planning (see diagrams) can save you time.
4. Keep offsets and lengths of laterals to a minimum to reduce vent resistance.
5. Strap the vent securely in position, always maintaining at least 1" clearance to combustibles. Firestops should be used where vents pass through floors, walls, or ceilings. (See Product Description section for Round Wall Thimble, Vent Collar, Bucket Support, Support Plate, Firestop Support Plate, and Oval Firestop Spacer.)
6. The vent termination must be securely guyed or braced if it extends more than 5' above the roof.
7. For longer-lasting durability and better appearance, all vents exposed to the weather (except caps) should be painted
8. Excessive exterior vents reduce venting action; therefore, such installations are not recommended.

For additional guidance in proper sizing of Type B Gas Vent refer to the **Venting Guidelines for Category I Gas Appliances** (Available on www.ameri-vent.com)



TYPICAL AMERIVENT TYPE B GAS VENT INSTALLATIONS - ROUND AND OVAL

TYPE BW

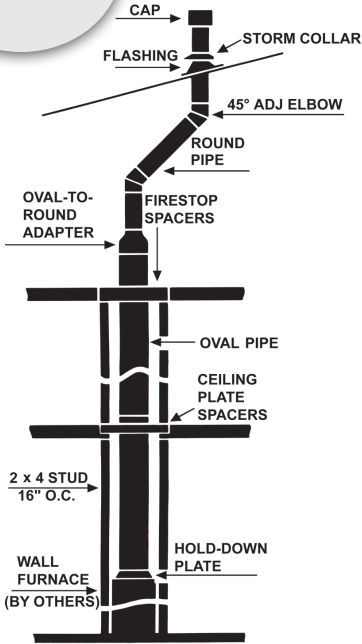

TYPE B 2X4
4" OR 5" OVAL IN
2X4 STUD WALL

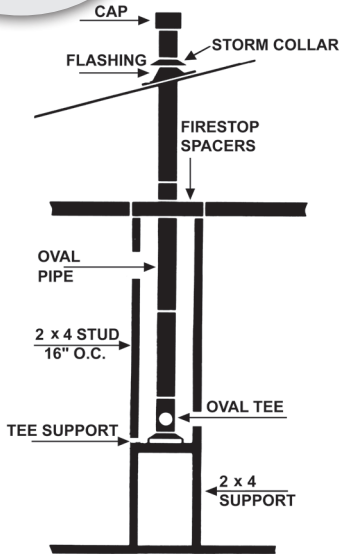

SINGLE
APPLIANCE

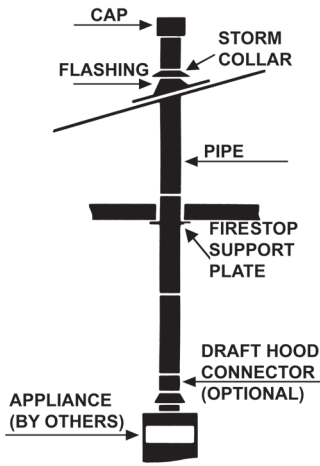

MULTIPLE
APPLIANCE
WITH MANIFOLD

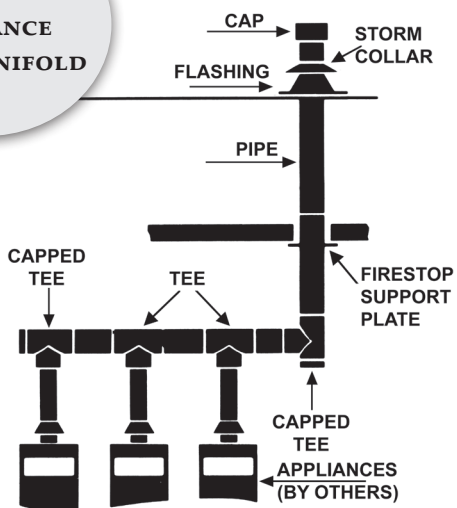

MULTIPLE
APPLIANCE

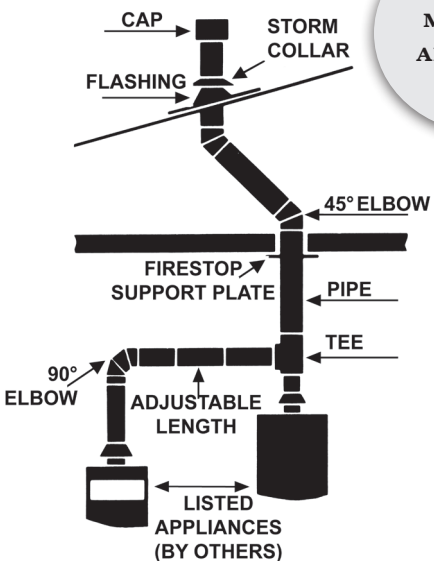

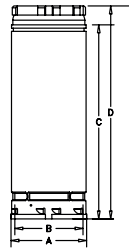
LENGTHS

Lengths - Round

- Made of corrosion-resistant galvanized steel and aluminum double-wall construction
- Snap-lock coupling for easy installation

PART #	SIZE	A - O.D.	B - I.D.	C	D
3E6	3"	3 1/2"	3"	5"	6"
3E12	3"	3 1/2"	3"	11"	12"
3E18	3"	3 1/2"	3"	17"	18"
3E24	3"	3 1/2"	3"	23"	24"
3E3	3"	3 1/2"	3"	35"	36"
3E4	3"	3 1/2"	3"	47"	48"
3E5	3"	3 1/2"	3"	59"	60"
4E6	4"	4 1/2"	4"	5"	6"
4E12	4"	4 1/2"	4"	11"	12"
4E18	4"	4 1/2"	4"	17"	18"
4E24	4"	4 1/2"	4"	23"	24"
4E3	4"	4 1/2"	4"	35"	36"
4E4	4"	4 1/2"	4"	47"	48"
4E5	4"	4 1/2"	4"	59"	60"
5E6	5"	5 1/2"	5"	5"	6"
5E12	5"	5 1/2"	5"	11"	12"
5E18	5"	5 1/2"	5"	17"	18"
5E24	5"	5 1/2"	5"	23"	24"
5E3	5"	5 1/2"	5"	35"	36"
5E4	5"	5 1/2"	5"	47"	48"
5E5	5"	5 1/2"	5"	59"	60"
6E6	6"	6 1/2"	6"	5"	6"
6E12	6"	6 1/2"	6"	11"	12"
6E18	6"	6 1/2"	6"	17"	18"
6E24	6"	6 1/2"	6"	23"	24"
6E3	6"	6 1/2"	6"	35"	36"
6E4	6"	6 1/2"	6"	47"	48"
6E5	6"	6 1/2"	6"	59"	60"
7R6	7"	8"	7"	5"	6"
7R12	7"	8"	7"	11"	12"
7R18	7"	8"	7"	17"	18"
7R24	7"	8"	7"	23"	24"
7R3	7"	8"	7"	35"	36"
7R4	7"	8"	7"	47"	48"
7R5	7"	8"	7"	59"	60"
8R6	8"	9"	8"	5"	6"
8R12	8"	9"	8"	11"	12"
8R18	8"	9"	8"	17"	18"
8R24	8"	9"	8"	23"	24"
8R3	8"	9"	8"	35"	36"
8R5	8"	9"	8"	59"	60"

PART #	SIZE	A - O.D.	B - I.D.	C	D
9R12	9"	10"	9"	11"	12"
9R18	9"	10"	9"	17"	18"
9R24	9"	10"	9"	23"	24"
9R3	9"	10"	9"	35"	36"
10R12	10"	11"	10"	11"	12"
10R18	10"	11"	10"	17"	18"
10R24	10"	11"	10"	23"	24"
10R3	10"	11"	10"	35"	36"
12R12	12"	13"	12"	11"	12"
12R18	12"	13"	12"	17"	18"
12R24	12"	13"	12"	23"	24"
12R3	12"	13"	12"	35"	36"
14R12	14"	15"	14"	11"	12"
14R18	14"	15"	14"	17"	18"
14R24	14"	15"	14"	23"	24"
14R3	14"	15"	14"	35"	36"
16R12	16"	17"	16"	11"	12"
16R18	16"	17"	16"	17"	18"
16R24	16"	17"	16"	23"	24"
16R3	16"	17"	16"	35"	36"
18R12	18"	19"	18"	11"	12"
18R18	18"	19"	18"	17"	18"
18R24	18"	19"	18"	23"	24"
18R3	18"	19"	18"	35"	36"
20R12	20"	21"	20"	11"	12"
20R18	20"	21"	20"	17"	18"
20R24	20"	21"	20"	23"	24"
20R3	20"	21"	20"	35"	36"
22R12	22"	23"	22"	11"	12"
22R18	22"	23"	22"	17"	18"
22R24	22"	23"	22"	23"	24"
22R3	22"	23"	22"	35"	36"
24R12	24"	25"	24"	11"	12"
24R18	24"	25"	24"	17"	18"
24R24	24"	25"	24"	23"	24"
24R3	24"	25"	24"	35"	36"
26R12	26"	27"	26"	11"	12"
26R18	26"	27"	26"	17"	18"
26R24	26"	27"	26"	23"	24"
26R3	26"	27"	26"	35"	36"
28R12	28"	29"	28"	11"	12"
28R18	28"	29"	28"	17"	18"
28R24	28"	29"	28"	23"	24"
28R3	28"	29"	28"	35"	36"
30R12	30"	31"	26"	11"	12"
30R18	30"	31"	26"	17"	18"
30R24	30"	31"	26"	23"	24"
30R3	30"	31"	26"	35"	36"



LENGTHS (CONTINUED)

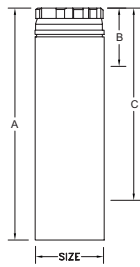

Adjustable Length - Round

- Adjustable lengths telescope into standard Amerivent pipe sections to reach desired length

PART #	PIPE SIZE	ADJ LENGTH	EXTENSION FROM B	LENGTH TO C
3E12A	3"	12"	3"	10"
4E12A	4"	12"	3"	10"
5E12A	5"	12"	3"	10"
6E12A	6"	12"	3"	10"
7R12A	7"	12"	3"	10"
8R12A	8"	12"	3"	10"
9R18A	9"	18"	3"	16"
10R18A	10"	18"	3"	16"
12R18A	12"	18"	3"	16"
14R18A	14"	18"	5"	16"
16R18A	16"	18"	5"	16"
18R18A	18"	18"	5"	16"
20R18A	20"	18"	5"	16"
22R18A	22"	18"	5"	16"
24R18A	24"	18"	5"	16"
26R18A	26"	18"	5"	16"
28R18A	28"	18"	5"	16"
30R18A	30"	18"	5"	16"

ELBOWS

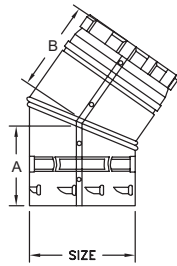

45° Elbow - Round

- Used to offset installation to avoid obstructions such as rafters and joists
- Size 3" through 14" adjust easily from 0° to 45°
- Sizes 16" through 30" are non-adjustable
- See the Gas Vent Offset Chart

PART #	SIZE	A	B
0° to 45° Adjustable			
3E45	3"	3"	2 3/4"
4E45	4"	3 1/8"	3 1/16"
5E45	5"	3 1/2"	3 1/2"
6E45	6"	4"	3 1/16"
7R45	7"	4 13/16"	4 1/4"
8R45	8"	4 3/4"	4 9/16"
9R45	9"	5"	5 3/8"
10R45	10"	5 7/8"	5 3/8"
12R45	12"	6"	5 3/8"
14R45	14"	6 5/8"	6 1/2"
Non-Adjustable			
16R45	16"	7"	7"
18R45	18"	7 1/2"	7 1/2"
20R45	20"	8"	7 5/8"
22R45	22"	8 1/2"	8 5/8"
24R45	24"	8 5/8"	8 1/16"
26R45	26"	9"	9"
28R45	28"	9 1/2"	9 1/2"
30R45	30"	10"	10"

TYPE B GAS VENT - ROUND

ELBOWS (CONTINUED)

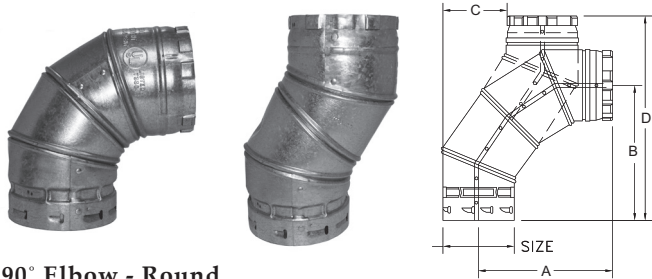

90° Elbow - Round

- Adjusts from 0° to 90° easily in order to clear rafters or ceiling joists
- Constructed of four sections for smoother bends and less resistance

PART #	SIZE	A	B	C	D
3EAL	3"	4 1/2"	5 1/4"	1 1/2"	8"
4EAL	4"	5"	5 1/2"	1 1/2"	8 3/4"
5EAL	5"	5 1/2"	6"	2 1/4"	9 1/4"
6EAL	6"	6 1/2"	7"	2 1/2"	10 1/4"
7RAL	7"	7 3/4"	8"	3"	12 1/4"
8RAL	8"	8 3/4"	9"	3 1/4"	13"

TEE COMPONENTS

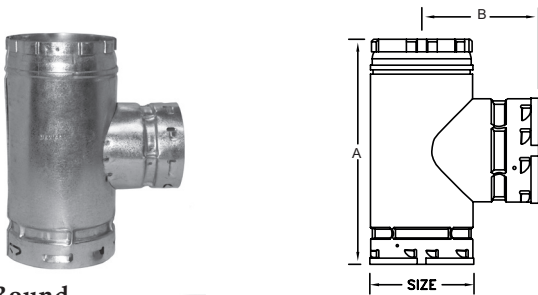

Tee - Round

- Transitions a system from horizontal to vertical orientation
- Branch and trunk diameters of the standard tee are the same size
- For smaller branch sizes, use a reducing tee up to 6" size
- For larger sizes, use an increaser with a standard tee

PART #	SIZE	A	B
3ET	3"	7 1/8"	4 1/8"
4ET	4"	8 7/8"	4 5/8"
5ET	5"	10"	5 1/4"
6ET	6"	11 1/2"	5 3/4"
7RT	7"	13"	6 1/2"
8RT	8"	14"	6 7/8"
9RT	9"	15"	7 3/4"
10RT	10"	16"	8 1/16"
12RT	12"	17 9/16"	9 3/4"
14RT	14"	24"	11 3/4"
16RT	16"	26"	13"
18RT	18"	28 1/2"	14 1/4"
20RT	20"	30"	15 1/2"
22RT	22"	33"	16 3/4"
24RT	24"	36"	18"
26RT	26"	38"	19"
28RT	28"	40"	20"
30RT	30"	42"	21"

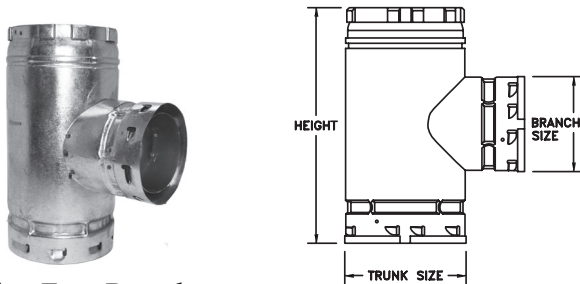

Reducing Tee - Round

- Features a branch with a smaller diameter than its trunk size, and provides a convenient connection of the furnace and water heater to a common vent

PART #	TRUNK SIZE	BRANCH SIZE	HEIGHT
4ET-3	4"	3"	8 7/8"
5ET-3	5"	3"	10"
5ET-4	5"	4"	10"
6ET-3	6"	3"	11 1/2"
6ET-4	6"	4"	11 1/2"
6ET-5	6"	5"	11 1/2"



TEE COMPONENTS (CONTINUED) PART #

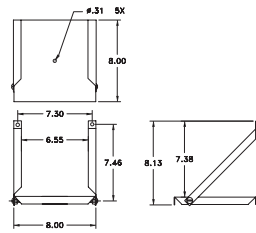

3-6SP

Tee Support Plate - Round

- Supports tee sizes 3" to 6"
- Used as a base for Type B gas vent

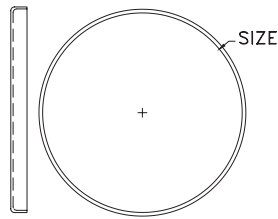
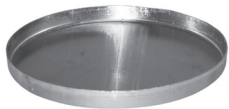

Round Tee Cap

- Used to close the bottom of a Tee or Wye

PART #	SIZE
3ETC	3"
4ETC	4"
5ETC	5"
6ETC	6"
7RTC	7"
8RTC	8"
9RTC	9"
10RTC	10"
12RTC	12"
14RTC	14"
16RTC	16"
18RTC	18"
20RTC	20"
22RTC	22"
24RTC	24"
26RTC	26"
28RTC	28"
30RTC	30"

TYPE B GAS VENT - ROUND

WYE

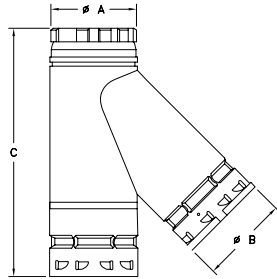

PART #	SIZE	A	B	C
4EY	4"	4 1/2"	4 1/2"	9"

Standard Wye - Round

- Used to common vent two or more appliances and provides better gas flow than a standard tee
- Features the branch, trunk, and base diameter with the same size

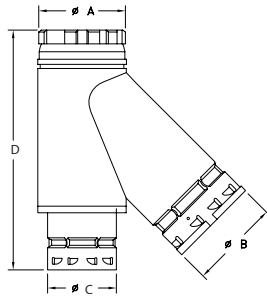

PART #	SIZE	A	B	C	D
4EY-3	4"	4 1/2"	3 1/2"	4 1/2"	9"
5EY-3	5"	5 1/2"	3 1/2"	5 1/2"	9"
5EY-4	5"	5 1/2"	4 1/2"	5 1/2"	10 1/2"
5EY-33	5"	5 1/2"	3 1/2"	3 1/2"	12"
5EY-34	5"	5 1/2"	3 1/2"	4 1/2"	12"
5EY-43	5"	5 1/2"	4 1/2"	3 1/2"	13 1/2"
5EY-44	5"	5 1/2"	4 1/2"	4"	13 1/2"
6EY-3	6"	6 1/2"	3 1/2"	6 1/2"	9"
6EY-4	6"	6 1/2"	4 1/2"	6 1/2"	10 1/2"
6EY-5	6"	6 1/2"	5 1/2"	6 1/2"	12"

Reduction Wye - Round

- Used to common vent two or more appliances and provides better gas flow than a standard tee
- Features a branch and/or base with a smaller diameter than the trunk size

VENT PIPE HANGERS

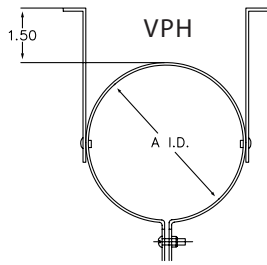

PART #	PIPE SIZE	A
3VPH	3" E	3 1/2"
4VPH	4" E	4 1/2"
5VPH	5" E	5 1/2"
6VPH	6" E	6 1/2"
7VPH	7" R	8"
6HS-SBA	8" R	9"
8HS-SBA	10" R	11"
10FB-SBA	12" R	13"

Vent Pipe Hanger - Round

- Provide support and resupport for offsets and horizontal runs of Amerivent gas vent
- VPH Vent Pipe Hanger provides 1 1/2" spacing
- SBA Vent Pipe Hanger provides 2" spacing



RAIN CAPS

- Used as a ventilation cap as well as a Type B gas vent termination
- Protects against wind conditions that can cause gases to spill back into the structure through the appliance draft hood
- UL-listed, and its patented design of ports and baffles keep rain and debris out of the vent
- Permits termination of vents at the minimum height necessary above the roof surface

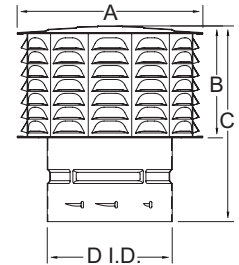
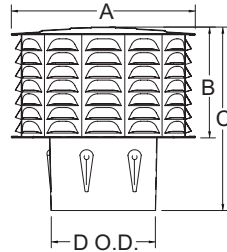

Model CW Universal Cap - Round

PART #	SIZE	A	B	C	D - O.D.
3CW	3"	6 3/4"	2 7/8"	4 3/4"	2 3/4"
4CW	4"	6 3/4"	4 3/8"	6 1/2"	3 7/8"
5CW	5"	9 7/8"	4 5/16"	7 3/8"	4 3/4"
6CW	6"	9 7/8"	5 3/4"	9"	5 3/4"
7CW	7"	12 7/8"	6 3/8"	9 3/16"	6 3/4"
8CW	8"	12 7/8"	7"	10"	7 5/8"

Model ECW or RCW Snap-Lock Cap - Round

PART #	SIZE	A	B	C	D - O.D.
3ECW	3"	6 3/4"	2 7/8"	5 5/16"	3 1/2"
4ECW	4"	6 3/4"	4 3/8"	7"	4 1/2"
5ECW	5"	9 7/8"	4 5/16"	7 3/8"	5 1/2"
6ECW	6"	9 7/8"	5 3/4"	9"	6 1/2"
7RCW	7"	12 7/8"	6 3/8"	9 1/2"	8"
8RCW	8"	12 7/8"	7"	10 5/16"	9"

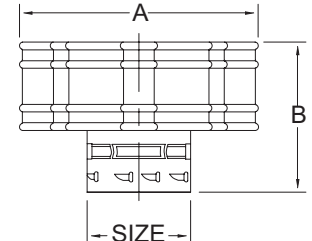
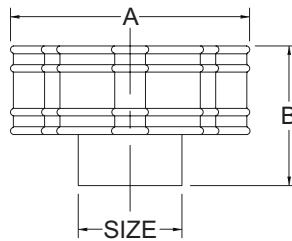

Model C Universal Cap - Round

PART #	SIZE	A	B
9C	9"	15 3/4"	7 1/2"
10C	10"	15 3/4"	7 1/2"
12C	12"	19"	9"
14C	14"	22"	11"
16C	16"	25"	12"
18C	18"	28 1/4"	13 1/2"
20C	20"	31 1/2"	15"
22C	22"	34 1/2"	16 1/2"
24C	24"	37 3/4"	18"
26C	26"	42"	19 1/2"
28C	28"	44"	21"
30C	30"	48"	22 1/2"

Model RC Snap-Lock Cap - Round

PART #	SIZE	A	B
9RC	9"	15 3/4"	7 1/2"
10RC	10"	15 3/4"	7 1/2"
12RC	12"	19"	9"
14RC	14"	22"	11"
16RC	16"	25"	12"
18RC	18"	28 1/4"	13 1/2"
20RC	20"	31 1/2"	15"
22RC	22"	34 1/2"	16 1/2"
24RC	24"	37 3/4"	18"
26RC	26"	42"	19 1/2"
28RC	28"	44"	21"
30RC	30"	48"	22 1/2"

UNIVERSAL VENT CAP

- Convenient solution for a variety of rooftop vent, flue*, and B-vent installations
- Self-centering, adjustable design means a quick, easy installation
- Worm Gear Clamp with one-tool adjustability
- Three sizes fit pipes with outside diameters from 3" to 8.5"
- Helps prevent rain, debris, and most birds from entering the vent
- Aluminum construction for rust and corrosion resistance
- Includes separate instruction sheet
- Listings: UL 441 and CAN/ULC-605

**Not to be used with solid fuel*

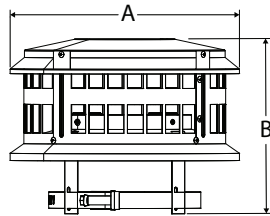

FITS O.D.	ORDER#	DESCRIPTION	CASE QTY.	A	B
3" - 4.5"	34UGVC"	3"-4" Universal Vent Cap	6	8"	5"
5" - 6.5"	56UGVC"	5"-6" Universal Vent Cap	6	11"	7 1/2"
7" - 8.5"	78UGVC"	7"-8" Universal Vent Cap	4	15"	8 1/4"



FIRESTOPS

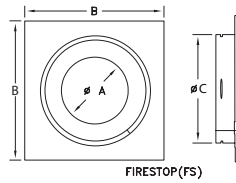
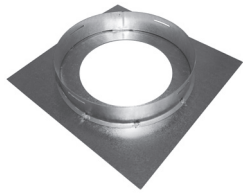

PART #	PIPE SIZE	A	B	C
3FS	3"	3 5/8"	7 1/2"	5 1/2"
4FS	4"	4 5/8"	8 1/2"	6 1/2"
5FS	5"	5 5/8"	9 1/2"	7 1/2"
6FS	6"	6 5/8"	10 1/2"	8 1/2"
7FS	7"	8 1/8"	12"	10"
8FS	8"	9 1/8"	13"	11"

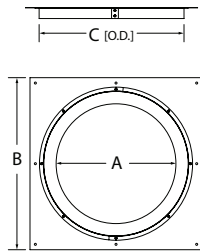
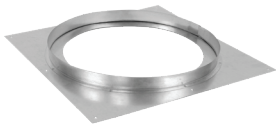

PART #	SIZE	A	B	C
10RFS	10"	11 1/8"	16"	13 1/2"
12RFS	12"	13 1/8"	18"	15 1/2"

Firestop Spacer

- Used to protect combustible materials where pipe passes through a ceiling or wall
- Includes integrated base plate

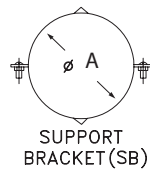

PART #	PIPE SIZE	A
3SB	3"	3 1/2"
4SB	4"	4 1/2"
5SB	5"	5 1/2"
6SB	6"	6 1/2"

Support Bracket

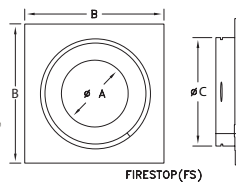
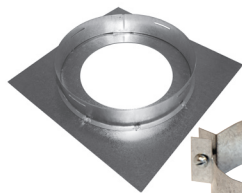

PART #	PIPE SIZE	A	B	D
3FSP	3"	3 5/8"	7 1/2"	5 1/2"
4FSP	4"	4 5/8"	8 1/2"	6 1/2"
5FSP	5"	5 5/8"	9 1/2"	7 1/2"
6FSP	6"	6 5/8"	10 1/2"	8 1/2"
7FSP	7"	8 1/8"	12"	10"
8FSP	8"	9 1/8"	13"	11"

Firestop Support

- Supports Type B gas vent starting at the appliance level and includes a support bucket
- Supports up to 20'
- Includes Firestop (FS) and Support Bracket (SB)

The support bracket (SB) and firestop (FS) are also available separately.

TYPE B GAS VENT - ROUND

FIRESTOP SUPPORT (CONTINUED)

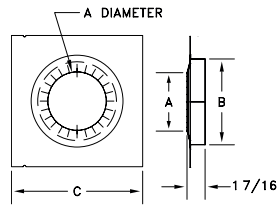
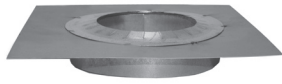

PART #	PIPE SIZE	A	B	C
3EGS	3"	3 1/2"	5 1/2"	9"
4EGS	4"	4 1/2"	6 1/2"	10"
5EGS	5"	5 1/2"	7 1/2"	11"
6EGS	6"	6 1/2"	8 1/2"	12"
7EGS	7"	8"	10"	13"
8EGS	8"	9"	11"	14"
9EGS	9"	10"	12"	15"
10EGS	10"	11"	13"	16"

Gripper Support - Round

- UL-listed as a support and firestop, the gripper support is strong enough to hold up to 30' of vent pipe
- Installs very quickly and allows for adjustment of the pipe to wherever needed
- A ring on the bottom provides the UL-required, one-inch clearance to combustibles (3" to 6" only; 7" to 10" are not UL-listed)
- No tools are required

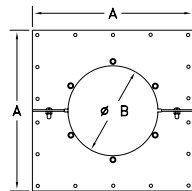
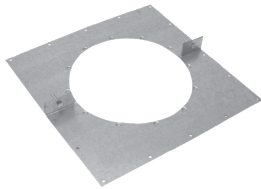

PART #	PIPE SIZE	A	B
9RSP	9"	17"	9 5/8"
10RSP	10"	18"	10 5/8"
12RSP	12"	20"	12 5/8"
14SP	14"	22"	14 5/8"
16SP	16"	24"	16 5/8"
18SP	18"	26"	18 5/8"
20SP	20"	28"	20 5/8"
22SP	22"	30"	22 5/8"
24SP	24"	32"	24 5/8"
26SP	26"	34"	26 5/8"
28SP	28"	36"	28 5/8"
30SP	30"	38"	30 5/8"

Support Plate - Round

- Designed to provide strength and durability for supporting large size pipe sections, and serves as a firestop
- Supports up to 30'

WALL THIMBLE

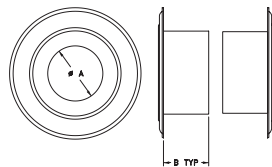

PART #	SIZE	A	B
3EWT	3"	3 9/16"	3 1/16"
4EWT	4"	4 9/16"	3 1/16"
5EWT	5"	5 9/16"	3 1/16"
6EWT	6"	6 9/16"	3 1/4"
7RWT	7"	8 1/16"	3 1/4"
8RWT	8"	9 1/16"	3 1/4"
9RWT	9"	10 1/16"	3 1/4"
10RWT	10"	11 1/16"	3 1/4"
12RWT	12"	13 1/16"	3 1/4"

Wall Thimble - Round

- Used to install pipe through an interior wall and provide proper clearance from combustibles
- The wall thimble adjusts for various wall thicknesses from 4" to 6"



FLASHINGS

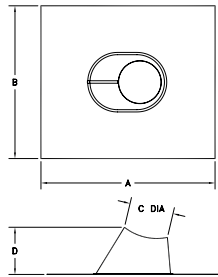
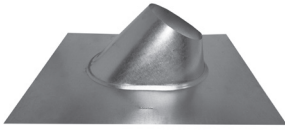

Standard Flashing - Round

- Used where the vent passes through the roof
- Fits flat to 6/12 pitch roof
- Built with double-seamed construction for protection from leakage

PART #	SIZE	A	B	C
3EF	3"	14 3/4"	12 1/2"	4"
4EF	4"	16 3/8"	13 3/4"	5"
5EF	5"	17 13/16"	15"	4 9/16"
6EF	6"	18 3/4"	16 1/8"	6"
7RF	7"	20"	17 7/8"	6 5/8"
8RF	8"	21"	21"	6 5/8"
9RF	9"	22"	22"	6 5/8"
10RF	10"	24 1/8"	24 1/8"	7 1/8"
12RF	12"	25 1/16"	25 1/16"	7 5/8"
14F	14"	28"	28"	9 1/4"
16F	16"	30 1/8"	30 1/8"	9 1/2"
18F	18"	31 1/2"	31 1/2"	10 1/2"
20F	20"	34"	34"	11"
22F	22"	34 1/2"	34 1/2"	12"
24F	24"	37"	37"	12 1/2"
26F	26"	43"	43"	12"
28F	28"	45"	45"	12"
30F	30"	46"	46"	13"

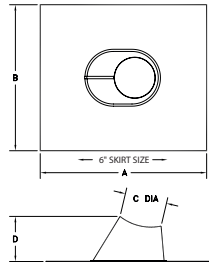

6" Skirt Standard Flashing - Round

- A standard flashing with a 6" skirt

PART #	SIZE	A	B	C
3EFFU	3"	20 1/4"	15 1/2"	4"
4EFFU	4"	20 1/4"	18"	5"
5EFFU	5"	24"	19"	4 9/16"
6EFFU	6"	24"	19"	6"
7RFFU	7"	25 1/16"	21 1/2"	6 5/8"
8RFFU	8"	25 1/16"	25 1/16"	6 5/8"
9RFFU	9"	26"	26"	6 5/8"
10RFFU	10"	29"	27"	7 1/8"
12RFFU	12"	29"	29"	7 5/8"
14RFFU	14"	32"	32"	8 1/8"

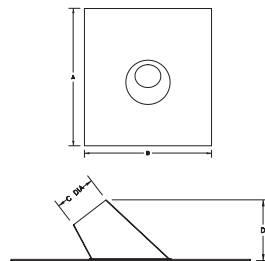
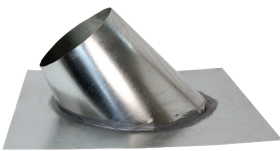

Steep Pitch Flashing - Round

- Handles roof pitches of 6/12 to 12/12

PART #	SIZE	A	B	C
3EF12	3"	17 7/8"	15"	6 1/2"
4EF12	4"	17 7/8"	15"	6 13/16"
5EF12	5"	22 5/8"	17"	7 1/2"
6EF12	6"	22 5/8"	17"	8"
7RF12	7"	21 13/16"	21 13/16"	8 7/8"
8RF12	8"	23 1/8"	23 1/8"	9 1/2"

FLASHINGS (CONTINUED)

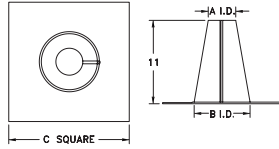

Tall Cone Flashing - Round

- Fits flat to 1/12 roof pitch
- Used on flat roofs in snow packed areas to reduce chances of snow covering vent

PART #	SIZE	A I.D.	B I.D.	C
3EFT	3"	3 5/8"	7 1/2"	16"
4EFT	4"	4 5/8"	7 1/2"	16"
5EFT	5"	5 5/8"	7 1/2"	16"
6EFT	6"	6 5/8"	7 1/2"	16"
7RFT	7"	8 1/8"	11"	18 1/16"
8RFT	8"	9 1/8"	11"	18 1/16"
10RFT	10"	11 1/8"	16"	24 1/8"
12RFT	12"	13 1/8"	16"	24 1/8"
14FT	14"	15 1/16"	19 5/16"	27"
16FT	16"	17 1/16"	19 5/16"	30"
18FT	18"	19 1/16"	23 1/16"	32 5/16"
20FT	20"	21 1/16"	23 1/16"	36"
22FT	22"	23 3/16"	27 1/16"	39"
24FT	24"	25 1/16"	27 1/16"	40"
26FT	26"	27 1/16"	31 1/16"	43"
28FT	28"	29 1/16"	31 1/16"	45"
30FT	30"	31 1/16"	35 1/16"	46"

VENT COLLARS

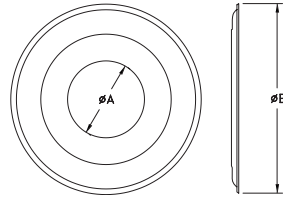

Vent Collar - Round

- The vent collar provides a cover for a rough wall opening
- Fits double-wall pipe only

PART #	SIZE	A I.D.	B
3EVC	3"	3 5/8"	8 3/4"
4EVC	4"	4 5/8"	8 3/4"
5EVC	5"	5 5/8"	10 7/8"
6EVC	6"	6 5/8"	12 7/8"
7RVC	7"	8 1/8"	14 7/8"
8RVC	8"	9 1/8"	16 7/8"
9RVC	9"	10 1/8"	18 7/8"
10RVC	10"	11 1/8"	20 7/8"
12RVC	12"	13 1/8"	22 7/8"



STORM COLLAR

- Used just above the flashing to provide protection from the weather
- Seal the inner edge with sealant against pipe



Fixed Storm Collar - Round

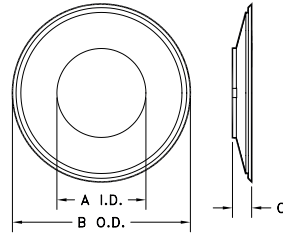

Adjustable Storm Collar - Round

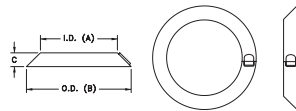

PART #	SIZE	A I.D.	B O.D.	C
Fixed				
3ESC	3"	3 1/2"	6 5/8"	1 7/16"
4ESC	4"	4 1/2"	7 5/8"	1 1/2"
5ESC	5"	5 1/2"	8 5/8"	1 5/8"
6ESC	6"	6 1/2"	9 5/8"	1 1/2"
Adjustable				
7RSC	7"	8"	10 7/8"	1 7/16"
8RSC	8"	9"	11 7/8"	1 7/16"
9RSC	9"	10"	13 3/16"	1 1/2"
10RSC	10"	11"	14 1/2"	1 3/4"
12RSC	12"	13"	16 1/2"	1 3/4"
14SC	14"	15"	18 1/2"	1 1/16"
16SC	16"	17"	21 1/4"	2 1/8"
18SC	18"	19"	23 3/4"	2 5/16"
20SC	20"	21"	25 1/16"	2 1/2"
22SC	22"	23"	28 5/16"	2 1/16"
24SC	24"	25"	30 1/16"	1 7/8"
26SC	26"	27"	33 1/16"	3 1/16"
28SC	28"	29"	35 1/16"	3 1/4"
30SC	30"	31"	37 1/16"	3 7/16"

ADAPTERS



Bucket Connector - Round

- (EBC) is used to make the connection of either Amerivent single-wall connector pipe, or Amerivent Type B Gas Vent, utilized as connector through the bottom of the Amerivent Bucket

PART #	SIZE
3EBC	3"
4EBC	4"
5EBC	5"
6EBC	6"
7EBC	7"
8EBC	8"



Draft Hood Connector - Round

- Connects Type B gas vent directly to an appliance draft hood
- The flexible inlet can be shaped to fit oval draft hood outlets

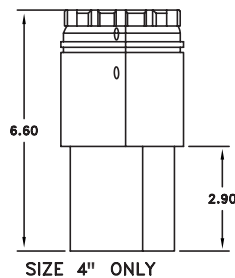

PART #	SIZE	A
3EDC	3"	6"
4EDC	4"	6.6"
5EDC	5"	6"
6EDC	6"	6"
7RDC	7"	6"
8RDC	8"	6"
9RDC	9"	7"
10RDC	10"	7"
12RDC	12"	7"

ADAPTERS (CONTINUED)

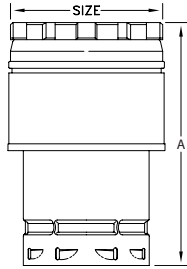

Increaser - Round

- Used to increase the vent size
- A max of four steps of increase

PART	SIZE
3EIX4	4"
3EIX5	5"
4EIX5	5"
3EIX6	6"
4EIX6	6"
5EIX6	6"
3EIX7	7"
4EIX7	7"
5EIX7	7"
6EIX7	7"

PART	SIZE
4EIX8	8"
5EIX8	8"
6EIX8	8"
7RIX8	8"
5EIX9	9"
6EIX9	9"
7EIX9	9"
8EIX9	9"
6EIX10	10"
7RIX10	10"
8RIX10	10"
9RIX10	10"

PART	SIZE
7RIX12	12"
8RIX12	12"
9RIX12	12"
10RIX12	12"
8RIX14	14"
9RIX14	14"
10RIX14	14"
12RIX14	14"
9RIX16	16"
10RIX16	16"
12RIX16	16"
14RIX16	16"
10RIX18	18"
12RIX18	18"
14RIX18	18"
16RIX18	18"
12RIX20	20"
14RIX20	20"
16RIX20	20"
18RIX20	20"

PART	SIZE
14RIX22	22"
16RIX22	22"
18RIX22	22"
20RIX22	22"
16RIX24	24"
18RIX24	24"
20RIX24	24"
22RIX24	24"
18RIX26	26"
20RIX26	26"
22RIX26	26"
24RIX26	26"
20RIX28	28"
22RIX28	28"
24RIX28	28"
26RIX28	28"
22RIX30	30"
24RIX30	30"
26RIX30	30"
28RIX30	30"

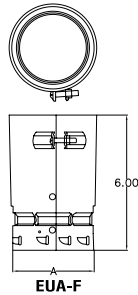

EUA-F Universal Female Adapter - Round

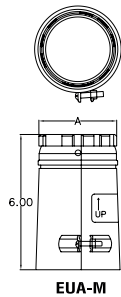

EUA-M Universal Male Adapter - Round

- Offers secure, listed connections between Amerivent Type B Gas Vent and other manufacturers' gas vents

PART #	SIZE	A
EUA-F Universal Female Adapter		
3EUA-F	3"	3 ½"
4EUA-F	4"	4 ½"
5EUA-F	5"	5 ½"
6EUA-F	6"	6 ½"
EUA-M Universal Male Adapter		
3EUA-M	3"	3 ½"
4EUA-M	4"	4 ½"
5EUA-M	5"	5 ½"
6EUA-M	6"	6 ½"



LENGTH - OVAL

Type B	Amerivent may be installed with 1" minimum clearance to combustibles. (Sizes 3" through 30" round and sizes 4", 5", and 6" oval)
Type BW	Four-inch oval Amerivent (when installed in 2 x 4 stud wall with recessed heater) requires clearances as determined by use of 40HD hold-down plate, 40PS ceiling plate spacers, and 40FS firestop spacers.
Type B 2x4	4" and 5" oval Amerivent (when installed in 2 x 4 stud wall with other than recessed heater) requires clearance as determined by use of 40FS or 50FS firestop spacers at ceiling level.

CLEARANCES

Underwriters' Laboratories' listed Minimum Clearance to Combustibles

Amerivent Description	Type	Type
Oval 4" <i>(when installed in 2x4 stud wall with recessed heater)</i>	BW	Clearances as determined by use of 40HD hold-down plate, 40PS ceiling plate spacers, and 40FS firestop spacers
Oval 4" and 5" <i>(when installed in 2x4 stud wall with other than recessed heater)</i>	B - 2x4	Clearance as determined by use of firestop spacers at each ceiling level
Oval 4", 5", 6"	B	1"
Round 3" through 30"	B	1"

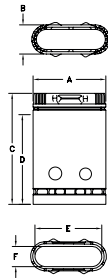
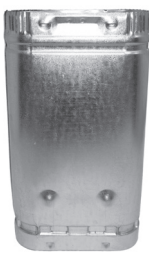

Lengths - Oval

The oval pipe offers all the advantages of Amerivent round pipe, and may be used for the following types of installation:

- 4" Oval:
*Conventional Type B,
Type B-2x4 when used with firestop Type BW*
- 5" Oval:
*Type B,
Type B-2x4*
- 6" Oval:
Type B

PART #	SIZE	A	B	C	D	E	F
406	4"	7 1/16"	2 7/8"	6"	4 3/4"	6 1/2"	2 1/4"
4012	4"	7 1/16"	2 7/8"	12"	10 3/4"	6 1/2"	2 1/4"
4018	4"	7 1/16"	2 7/8"	18"	16 3/4"	6 1/2"	2 1/4"
4024	4"	7 1/16"	2 7/8"	24"	22 3/4"	6 1/2"	2 1/4"
403	4"	7 1/16"	2 7/8"	36"	34 3/4"	6 1/2"	2 1/4"
404	4"	7 1/16"	2 7/8"	48"	46 3/4"	6 1/2"	2 1/4"
405	4"	7 1/16"	2 7/8"	60"	58 3/4"	6 1/2"	2 1/4"
506	5"	10 3/4"	2 7/8"	6"	4 3/4"	9 3/4"	2 1/4"
5012	5"	10 3/4"	2 7/8"	12"	10 3/4"	9 3/4"	2 1/4"
5018	5"	10 3/4"	2 7/8"	18"	16 3/4"	9 3/4"	2 1/4"
5024	5"	10 3/4"	2 7/8"	24"	22 3/4"	9 3/4"	2 1/4"
503	5"	10 3/4"	2 7/8"	36"	34 3/4"	9 3/4"	2 1/4"
504	5"	10 3/4"	2 7/8"	48"	46 3/4"	9 3/4"	2 1/4"
505	5"	10 3/4"	2 7/8"	60"	58 3/4"	9 3/4"	2 1/4"
606	6"	11 1/2"	3 1/4"	6"	4 3/4"	10 7/8"	2 5/8"
6012	6"	11 1/2"	3 1/4"	12"	10 3/4"	10 7/8"	2 5/8"
6018	6"	11 1/2"	3 1/4"	18"	16 3/4"	10 7/8"	2 5/8"
6024	6"	11 1/2"	3 1/4"	24"	22 3/4"	10 7/8"	2 5/8"
603	6"	11 1/2"	3 1/4"	36"	34 3/4"	10 7/8"	2 5/8"

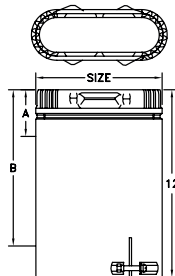
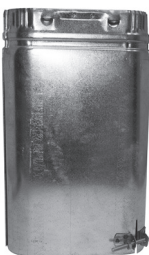

Adjustable Length - Oval

- The adjustable length telescopes onto standard pipe sections to permit adjustments from 3" to 10" to reach desired installation length

PART #	SIZE	A - MIN. LENGTH	B - MAX. LENGTH
4012A	4"	3"	10"
5012A	5"	3"	10"
6012A	6"	3"	10"

ELBOWS

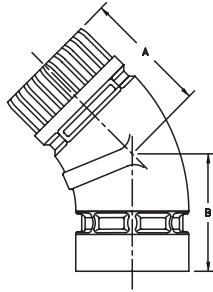

PART #	SIZE	A	B
4045S	4"	3"	3"
5045S	5"	3 1/2"	3 1/2"
6045S	6"	4"	4"

45° Standard Elbow - Oval

- Used in pairs where offsets are desired in 1" minimum clearance enclosures or open spaces, such as attics or basements
- Add pipe sections between pairs to produce additional offset

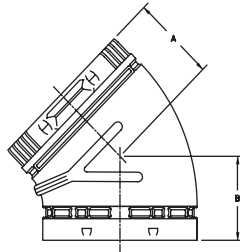

PART #	SIZE	A	B
4045F	4"	3 3/4"	3 3/4"
5045F	5"	4 3/4"	4 3/4"
6045F	6"	5"	5"

45° Flat Elbow - Oval

- Used in pairs where offsets are desired in 1" minimum clearance enclosures or open spaces, such as attics or basements
- Add pipe sections between pairs to produce additional offset

TEE COMPONENTS

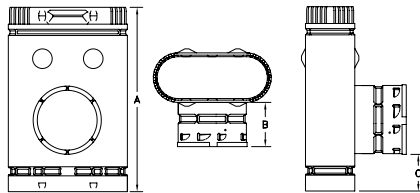

PART #	SIZE	A	B	C
40T	4"	12"	2 9/16"	2 3/8"
50T	5"	12"	2 9/16"	2 3/8"
60T	6"	12"	2 5/8"	2 3/4"

Oval Tee

- The branch size and trunk size have equivalent diameter
- The tee branch accepts either double or single wall pipe

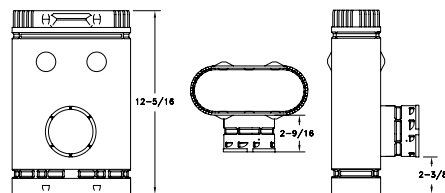

PART #	SIZE	A	B	C
40T-3	4"	12"	2 9/16"	2 3/8"

Oval Reducing Tee

- The branch size of the reducing tee is one inch smaller than the trunk size



TEE COMPONENTS (CONTINUED)

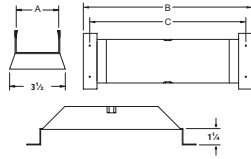
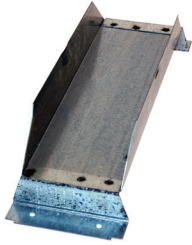

PART #	SIZE	A	B	C
40TS	4"	3"	11 1/2"	10 5/8"
50TS	5"	3"	12 7/8"	12"
60TS	6"	3 3/4"	14 1/4"	13 3/8"

Oval Tee Support

- Used to support and center the oval tee
- Use with the tee cap (0TC)

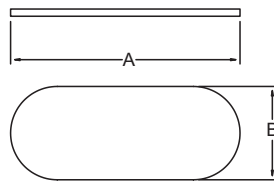
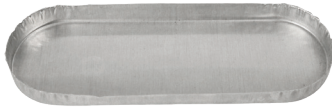

PART #	SIZE	A	B
40TC	4"	6 3/16"	2 1/4"
50TC	5"	9 7/8"	2 1/4"
60TC	6"	10 5/8"	2 5/8"

Oval Tee Cap

- Used for closing off the bottom of a tee

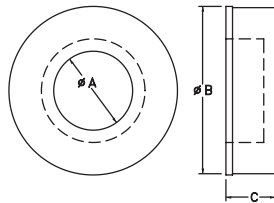

PART #	SIZE	A	B	C
3-40TVC	4"	3 1/8" - 4 1/8"	6 3/4"	2"
50TVC	5"	5 1/8"	6 3/4"	2"
60TVC	6"	6 1/8"	8 3/4"	2"

Oval Tee Collar

- May be used to cover the rough wall opening and the exposed double-wall connector
- The 3 - 40TVC collar features a knock-out for a 3" or 4" single wall connector

VENT KIT



Oval Vent Kit

PART # DESCRIPTION

40V-VK	Oval Vent Kit
Includes:	4"x24" Pipe Section Qty 2 (4024)
	Oval to Round Adapter (40E)
	4" Oval Type BW Hold-Down Plate (40HD)
	4" Type BW Plate Spacers (40PS)

RAIN CAPS

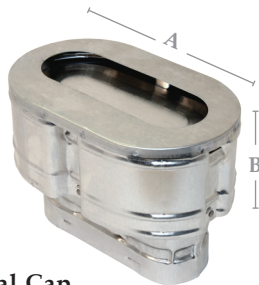

Oval Cap

- Model 0CA (Locking)
- Model 0C (Universal)

PART #	SIZE	A	B
40CA	4" oval	5 3/8" x 8 1/2"	3 1/2"
40C	4" oval	5 3/8" x 8 1/2"	3 1/2"

The 5" and 6" oval vents use an Oval to Round Adapter (0E) and a Round Cap (CW or ECW).

FLASHINGS

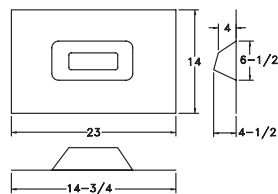
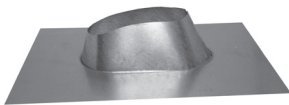

PART # SIZE

40F	4"
50F	5"
60F	6"

All-Pitch Flashing - Oval

- Installed either parallel or perpendicular to the roof ridge
- Fits roof pitches flat to 5/12



PLATES, SHIELDS, SPACERS		PART #	SIZE	WALL SIZE	A	B	C
		40FS	4"	2" X 4"	7 1/4"	1 1/2"	2"
		50FS	5"	2" X 4"	10 13/16"	1 1/2"	2"
		40FS-6	4"	2" X 6"	7 1/4"	1 1/2"	3"
		50FS-6	5"	2" X 6"	10 13/16"	1 1/2"	3"
		60FS	6"	2" X 6"	11 9/16"	1 11/16"	3"

Firestop Spacers - Oval

- This centers the vent in 16" O.C. stud space and serves as a firestop at the ceiling level
- A required component for Type B 2 x 4 and multi-story Type BW installations

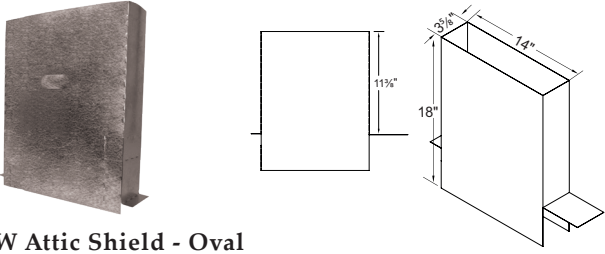

PART #
AVS

Type BW Attic Shield - Oval

- Used on a single-story building or on the top story of a multi-story building for Type BW gas vent
- The 26 gauge galvanized sheet metal extends down from the attic to the top of the ceiling plate
- Required by Los Angeles Code and UMC

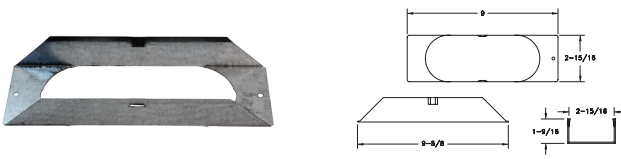

PART #	SIZE
40HD	4"

Type BW Hold-Down Plate - Oval

- Required for connecting Type BW vent to a wall furnace outlet

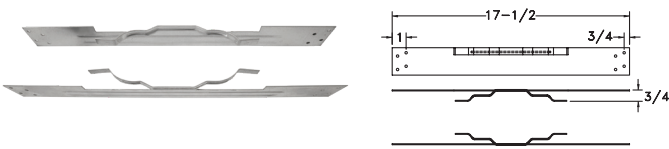

PART #	SIZE
40PS	4"

Type BW Plate Spacers - Oval

- Required at the first ceiling level above a wall furnace
- The spacers center and provide the required opening between floors
- Firestop spacers must be used at subsequent levels



PART #
40BW

Type BW Installation Kit - Oval

- One pair of Type BW plate spacers (40PS)
- One BW hold-down plate (40HD)

STORM COLLARS

PART # SIZE

40SC	4"
50SC	5"
60SC	6"



Oval Storm Collar

- Used to provide a weather proof seal to an oval pipe above a roof line
- Installed above the oval flashing
- Seal inner edge with sealant

ADAPTERS

PART # SIZE

40IX5	4"
-------	----

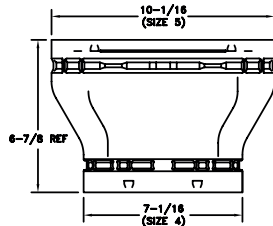

Oval Increaser

- Permits vent to be increased from 4" oval to 5" oval

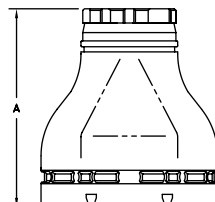

Oval to Round

PART #	SIZE	A
40E	4"	6 7/8"
50E	5"	9 3/8"
60E	6"	10 3/8"

Oval-to-Round Adapter

- The oval-to-round adapter is used for conversion of vent from oval to round

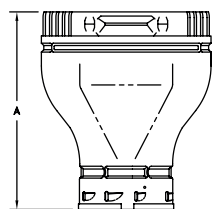

Round to Oval

PART #	SIZE	A
4EO	4"	6 7/8"
5EO	5"	9 3/8"
6EO	6"	10 3/8"

Round-to-Oval Adapter

- The round-to-oval adapter is used for conversion of vent from round to oval



GAS VENT CONNECTORS

Specifications and Dimensions

	Double-Wall Segment	Single-Wall Segment
Available Flexible Pipe Sizes:	3", 4", 5"	3", 4", 5"
Available Lengths:	24", 36", 48", 60"	12", 24", 36", 48", 60"
Usage	The double-wall flexible gas vent segment can be used as a connector or a segment of a Type B gas vent system. That means it can be installed in unconditioned spaces, such as attics and crawl spaces, anywhere Type B gas vent is used, except where it passes through walls, ceilings, floors, or the roof.	Single-wall flexible gas vent connectors connect appliances to double-wall Type B gas vent. Amerivent gas vent connectors are used with listed gas appliances with draft hoods or other gas appliances listed for use with Type B gas vent. They cannot be used in unconditioned spaces.
Material / Thickness	Flexible Pipe:	Aluminum Alloy 3003 .012" thickness
	Single-wall Ends:	Aluminum-zinc coated steel .018" thickness
	Rigid Components:	Aluminum-zinc coated steel .018" thickness
Clearances	1" to combustibles. Do not enclose. Do not pass through walls, floors or ceilings	
Approved, Accepted, or Listed by	AGA, NFPA, HUD, NBC, UBC, UL	

TYPICAL GAS VENT CONNECTORS INSTALLATIONS

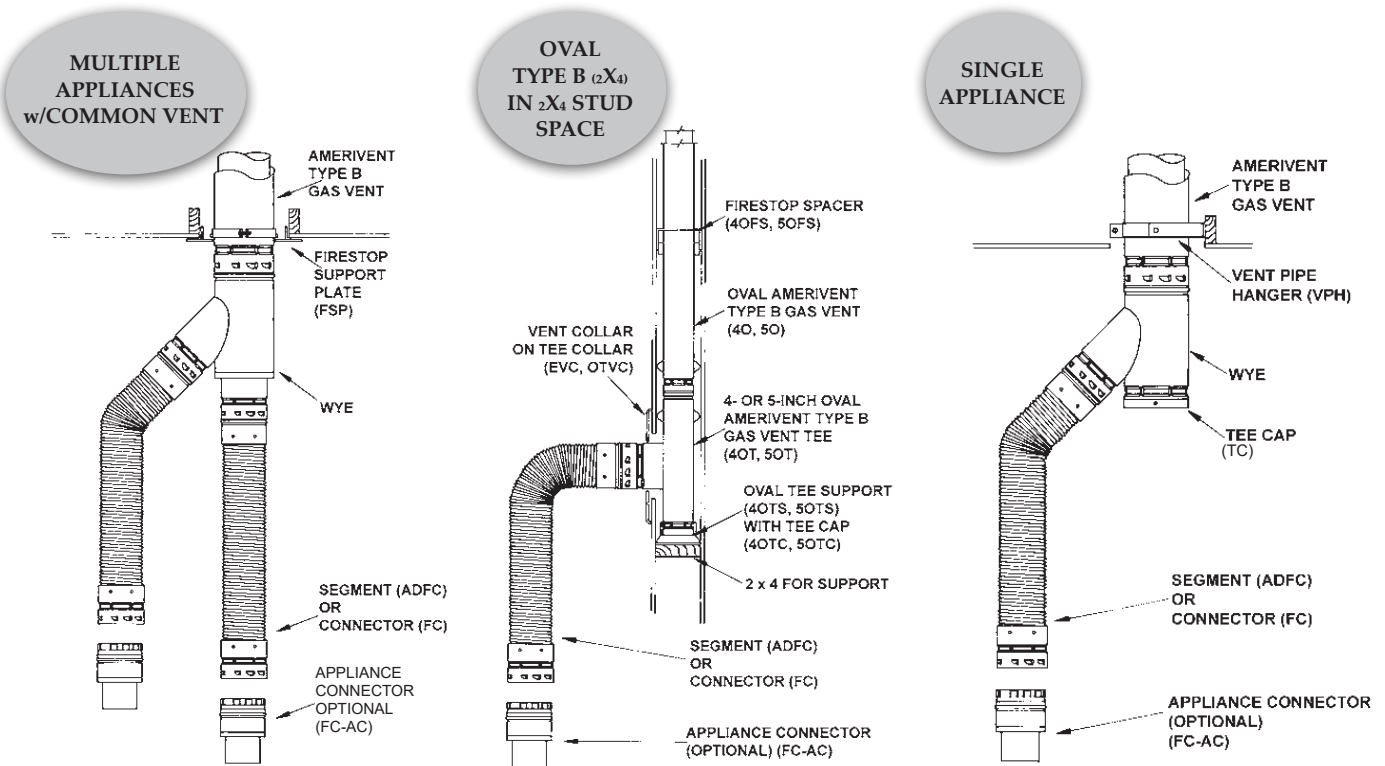

LENGTHS

Double-Wall Gas Vent Lengths



- Double-wall corrugated aluminum with B vent ends can be used anywhere B vent is used, except where it passes through walls, floors, ceiling, and inside enclosures
- May be compressed to fit

PART #	A	B
3ADFC24	3"	24"
3ADFC3	3"	36"
3ADFC4	3"	48"
3ADFC5	3"	60"
4ADFC24	4"	24"
4ADFC3	4"	36"
4ADFC4	4"	48"
4ADFC5	4"	60"

Single-Wall Gas Vent Lengths

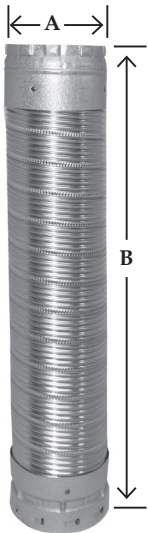

- Single-wall corrugated aluminum easily connects from the appliance to Amerivent Type B gas vent
- May be compressed 4" per foot to shorten length
- Sturdy galvalume ends offer proven snap-lock design
- This product can only be used in the room with the equipment in occupied spaces, not in unoccupied spaces such as attics or crawl spaces
- It cannot be used to pass through a wall, roof or ceiling, and cannot be totally enclosed

PART #	A	B
3FC12	3"	12"
3FC24	3"	24"
3FC3	3"	36"
3FC4	3"	48"
3FC5	3"	60"
4FC12	4"	12"
4FC24	4"	24"
4FC3	4"	36"
4FC4	4"	48"
4FC5	4"	60"
5FC12	5"	12"
5FC24	5"	24"
5FC3	5"	36"
5FC4	5"	48"
5FC5	5"	60"

ASSEMBLIES



PART #	6 PACK CONSISTS OF
R3FCA-24	6 ea of 24" length
R3FCA-3	6 ea of 36" length

- Assemblies consist of a single-wall flexible connector with an appliance connector and a universal adapter pre-attached
- An assembly allows easy connection from an appliance to any brand of B vent
- 3" diameter



WYES

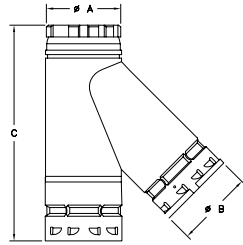

PART #	SIZE	A	B	C
3FCY	3"	3 1/2"	3 1/2"	9"
4FCY	4"	4 1/2"	4 1/2"	10 1/2"

Standard Single-Wall Wye

- The branch, trunk, and base diameters of the standard single-wall wye are the same size

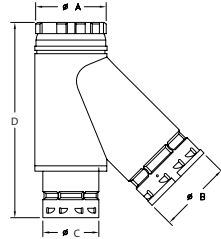

PART #	SIZE	A	B	C	D
4FCY-3	4"	4 1/2"	4 1/2"	3 1/2"	9"
4FCY-33	4"	4 1/2"	3 1/2"	3 1/2"	12"
5FCY-34	5"	5 1/2"	4 1/2"	3 1/2"	12"
5FCY-44	5"	5 1/2"	4 1/2"	3 1/2"	13 1/2"
5FCY-43	5"	5 1/2"	3 1/2"	3 1/2"	13 1/2"

Reduction Single-Wall Wye

- Features a branch and/or base with a diameter smaller than the trunk size
- Convenient connection for furnace and water heater into a common connector

ADAPTERS

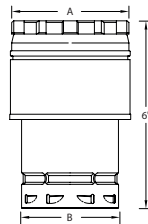

PART #	SIZE	A	B
3FCX4	4"	4 1/2"	3 1/2"
3FCX5	5"	5 1/2"	3 1/2"
3FCX6	6"	6 1/2"	3 1/2"
4FCX5	5"	5 1/2"	4 1/2"
4FCX6	6"	6 1/2"	4 1/2"
5FCX6	6"	6 1/2"	5 1/2"

Single-Wall Increaser

- Used to increase the connector diameter

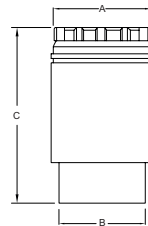

PART #	SIZE	A	B	C
3FC-AC	3"	3 1/2"	3"	6"
4FC-AC	4"	4 1/2"	4"	6"
5FC-AC	5"	5 1/2"	5"	6"

Single-Wall Appliance Connector

- Sized to fit outlet
- Use sheet metal screws for code approved appliance connection

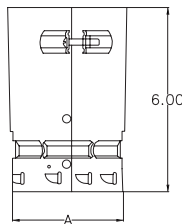

PART #	SIZE	A
3FCA	3"	3 1/2"
4FCA	4"	4 1/2"
5FCA	5"	5 1/2"

Single-Wall Universal Adapter

- Provides a short slip connection with the Amerivent single-wall snaplock base

FLEXI-LINER ALUMINUM CHIMNEY LINER KITS

- Kits include Flexible length, round top, flashing, mortar guard
- Standard kit lengths of 25' and 35' (15' available for 3", 4", 5")
- Available in 3", 4", 5", 5½", 6", 7" and 8" diameters in both kits and 10' extensions
- 10' insulated sleeve has tough polyethylene exterior
- Extension kit includes Flexi-Liner length with flex connector and fastener package
- Pull-downs stretch and lead the Flexi-Liner down the chimney and assist in pulling insulated sleeve over liner

Specifications

Liner Material	Aluminum 3003, 2-ply (0.005" each)
Maximum Flue Gas Temp	470°F
Available Size Range	3" to 8" diameter
Standard Kit Length	25' and 35'
Stretch Ratio	5:1 (approximate)
Clearances	0" between liner and chimney interior 0" between combustible materials and chimney exterior

PART #	SIZE
Universal B-Vent Adapters	
3ALK-VA	3"
4ALK-VA	4"
5ALK-VA	5"
6ALK-VA	6"
7ALK-VA	7"
8ALK-VA	8"
Flex Connectors	
3ALK-FC	3"
4ALK-FC	4"
5ALK-FC	5"
55ALK-FC	5 ½"
6ALK-FC	6"
7ALK-FC	7"
8ALK-FC	8"
Pull-Downs	
3FX-PD	3"
4FX-PD	4"
5FX-PD	5"
55FX-PD	5 ½"
6FX-PD	6"
7FX-PD	7"
8FX-PD	8"

PART # SIZE & WIDTH LENGTH
Kit Aluminum

3ALK15	3"	15'
3ALK25	3"	25'
3ALK35	3"	35'
4ALK15	4"	15'
4ALK25	4"	25'
4ALK35	4"	35'
5ALK15	5"	15'
5ALK25	5"	25'
5ALK35	5"	35'
55ALK25	5 ½"	25'
55ALK35	5 ½"	35'
6ALK25	6"	25'
6ALK35	6"	35'
7ALK25	7"	25'
7ALK35	7"	35'
8ALK25	8"	25'
8ALK35	8"	35'

Extension Kits

3ALKE10	3"	10'
3ALKE25	3"	25'
3ALKE35	3"	35'
4ALKE10	4"	10'
4ALKE25	4"	25'
4ALKE35	4"	35'
5ALKE10	5"	10'
5ALKE25	5"	25'
5ALKE35	5"	35'
55ALKE10	5 ½"	10'
55ALKE25	5 ½"	25'
55ALKE35	5 ½"	35'
6ALKE10	6"	10'
6ALKE25	6"	25'
6ALKE35	6"	35'
7ALK10	7"	10'
7ALK25	7"	25'
7ALK35	7"	35'
8ALK10	8"	10'
8ALK25	8"	25'
8ALK35	8"	35'

Insulated Sleeves

4ALK-FS	3" to 4"	10'
5ALK-FS	5"	10'
6ALK-FS	5 ½" to 6"	10'
7ALK-FS	7"	10'
8ALK-FS	8"	10'



Recommended Installations for Listed Gas Appliances

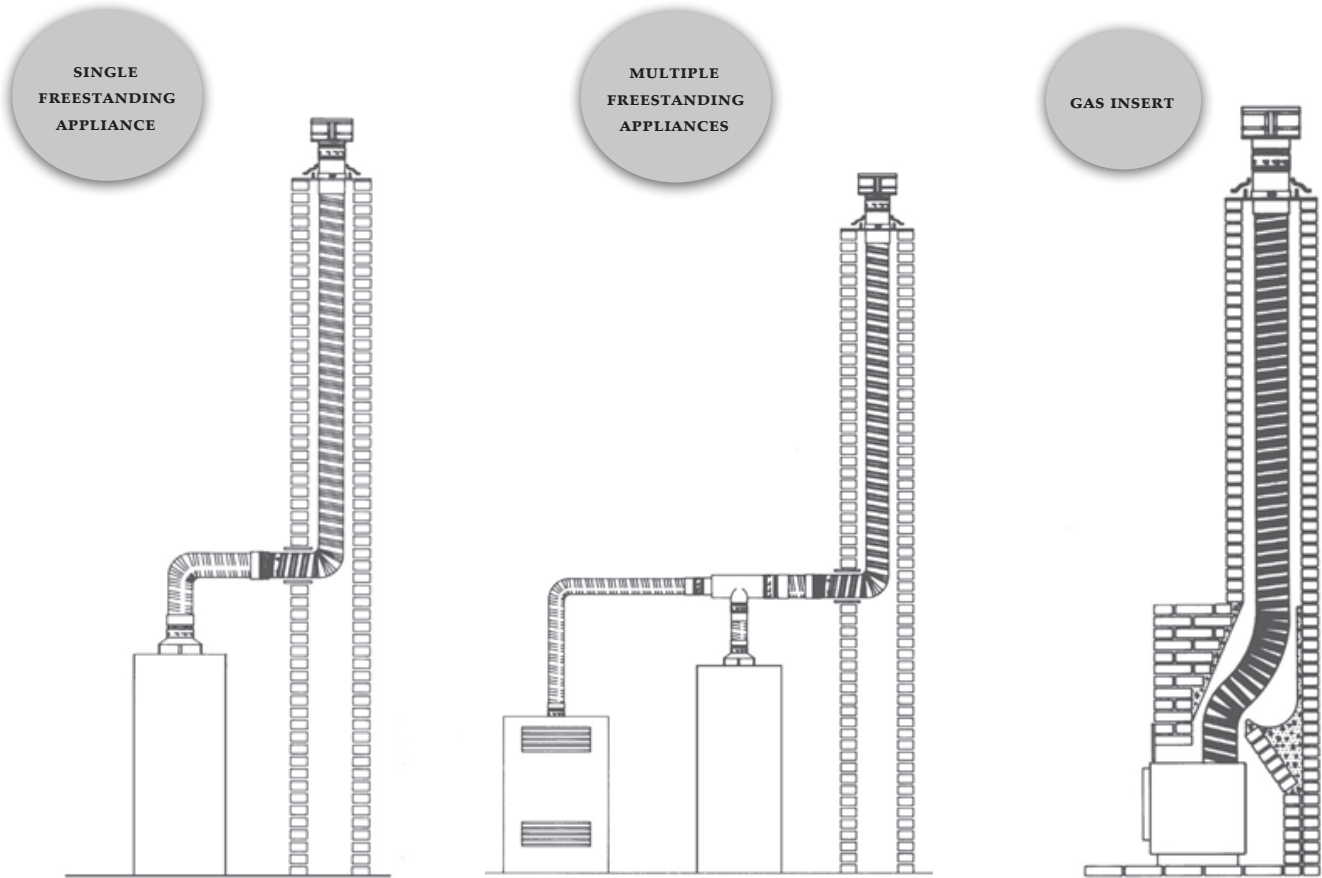

Note: Installations are shown with Amerivent flexible single-wall connectors.

Freestanding appliances may also use Amerivent Type B gas vent or code-approved single-wall material between appliance and liner.



BUILD FOR THE FUTURE

Our Portfolio of Brands

Airmate®	www.airmate.com
Ameriflow®	www.ameriflowregisters.com
Amerivent®	www.ameri-vent.com
AMPCO®	www.ampcostacks.com
Builder's Best®	www.buildersbest.com
Duravent™	www.duravent.com
Hart & Cooley®	www.hartandcooley.com
Heatfab®	www.heatfab.com
Lima®	www.limaregister.com
Milcor®	www.milcorinc.com
Portals Plus™	www.portalsplus.com
RPS™	www.rpscyrbs.com
Security Chimneys®	www.securitychimneys.com
Selkirk®	www.selkirkcorp.com

Corporate Headquarters

Duravent Group
28 W. Adams, Suite 1810
Detroit, MI 48226
Tel: 800.835.4429
Email: info@duraventgroup.com
www.duraventgroup.com

Contact Us

For more information about our products or to contact us directly, please go to any of our websites and click on the Contact section on the website.

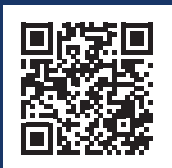

For warranty information:
Scan this QR code or visit
www.duraventgroup.com/warranties

duravent[™]
GROUP

BUILD FOR THE FUTURE

www.duraventgroup.com

